

	Vis BHC	4	M8x30 Zinguées	
C7	Barres de Contrôle	4	Tôle Acier ép.5mm	Laser
C6	Rives	4	Tube Acier 40x20x2	1 lg 2500
C5	Bouchons	4	Tôle Acier ép.3mm	Laser
C4	Goussets	14	Tôle Acier ép.5mm	Laser
C3	Bouchons	2	Tôle Acier ép.5mm	Laser
C2	Tablier supérieur	1	Tôle Acier ép.3mm	Laser
C1	Tablier inférieur	1	Tôle Acier ép.3mm	Laser
<b>C</b>	<b>MODULE C</b>	<b>1</b>	<b>ACIER</b>	<b>-</b>
B6	Poteaux	4	Tube Acier 60x30x3	1 lg 2000
B5	Bouchons	4	Tôle Inox ép.2mm	Laser
B4	Jambages	2	Tôle Inox ép.2mm	Laser
B3	Jambages	2	Tôle Inox ép.2mm	Laser
B2	Oreilles	16	Tôle Acier ép.5mm	Laser
B1	Pied de Poteaux	2	Tôle Acier ép.5mm	Laser
<b>B</b>	<b>MODULE B</b>	<b>1</b>	<b>ACIER / INOX</b>	<b>-</b>
	Ecrous	8	M8 Zingués	
	Rondelles	8	M8 Zinguées	
	Vis BHC	4	M8x20 Zinguées	
A4	Poteaux	4	Tube Acier Ø 88.9x5	1 lg 500
A3	Tête de socle	2	Tôle Acier ép.5mm	Laser
A2	Gousset	2	Tôle Acier ép.5mm	Laser
A1	Pied de Socle	2	Tôle Acier ép.8mm	Laser
<b>A</b>	<b>MODULE A</b>	<b>1</b>	<b>ACIER</b>	<b>-</b>
<b>REPERE</b>	<b>DESIGNATION</b>	<b>Qté</b>	<b>MATIERE</b>	<b>PRE-DEBIT</b>

### NOMENCLATURE

" OLYMPIADES DES METIERS "

OBJECTIF : ABU DHABI 2017

1 / 5

**FINALE NATIONALE  
METALLERIE / BORDEAUX 2017**  
**PLANS DE FABRICATION**



RÉGION NOUVELLE-AQUITAINE

Dess : Equipe Métier Projection : Echelle : Métier : 42 Temps :  
Date : 25 / 02 / 2017 Aucune Métallerie 16H30

1 D

## Pont Jacques - CHABAN - DELMAS / BORDEAUX

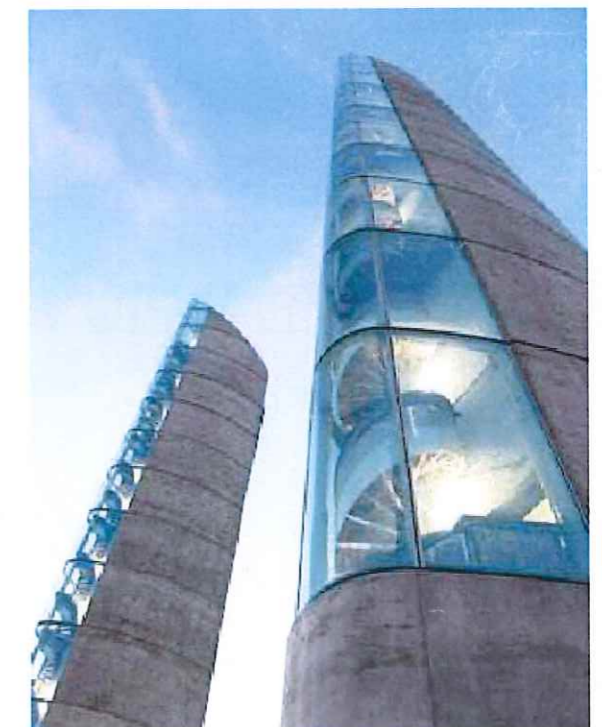
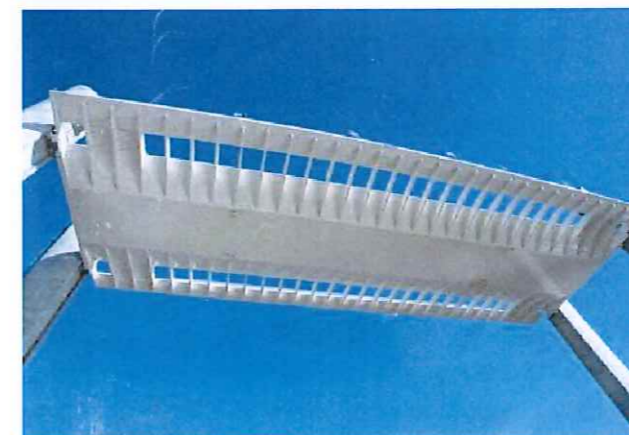
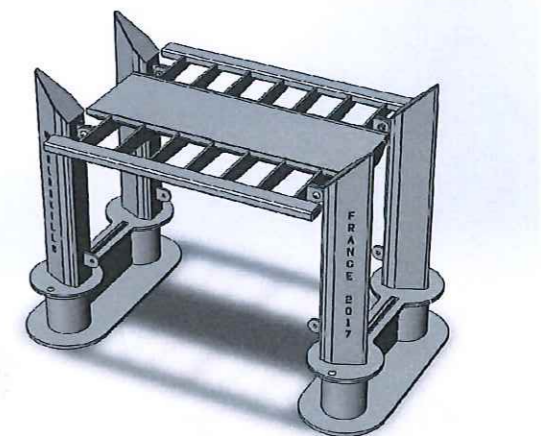
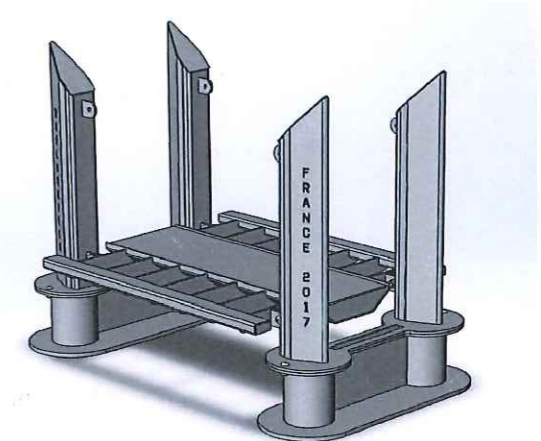

worldskills  
AbuDhabi2017  
مسابقة المهارات العالمية أبوظبي 2017

14-19 October 2017

[www.worldskillsabudhabi2017.com](http://www.worldskillsabudhabi2017.com)

**VUE DE COTE TRANSVERSALE  
EXTERIEURE**

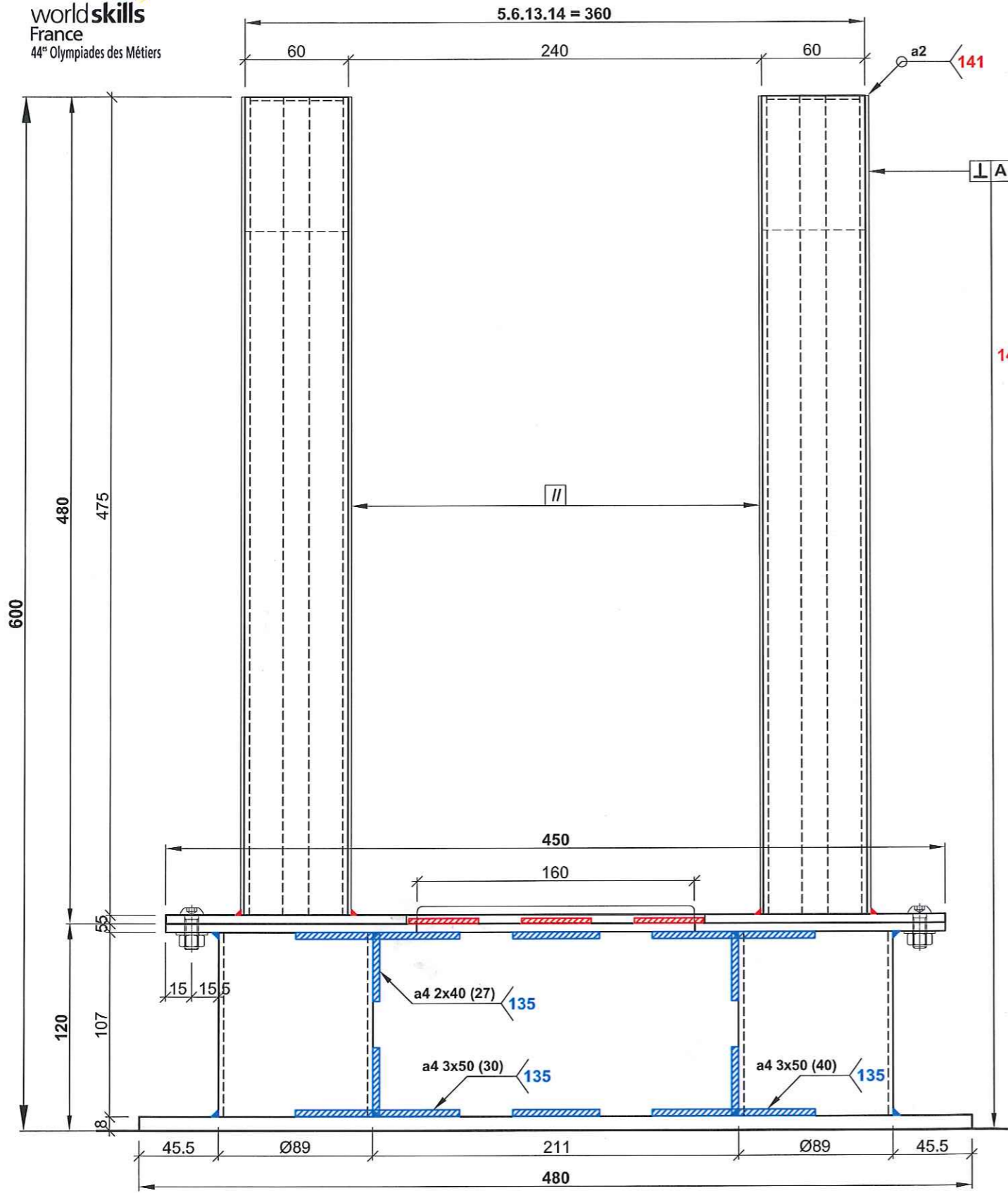

**1 Module Bas soudé 135**

**COUPE TRANSVERSALE  
INTERIEURE**

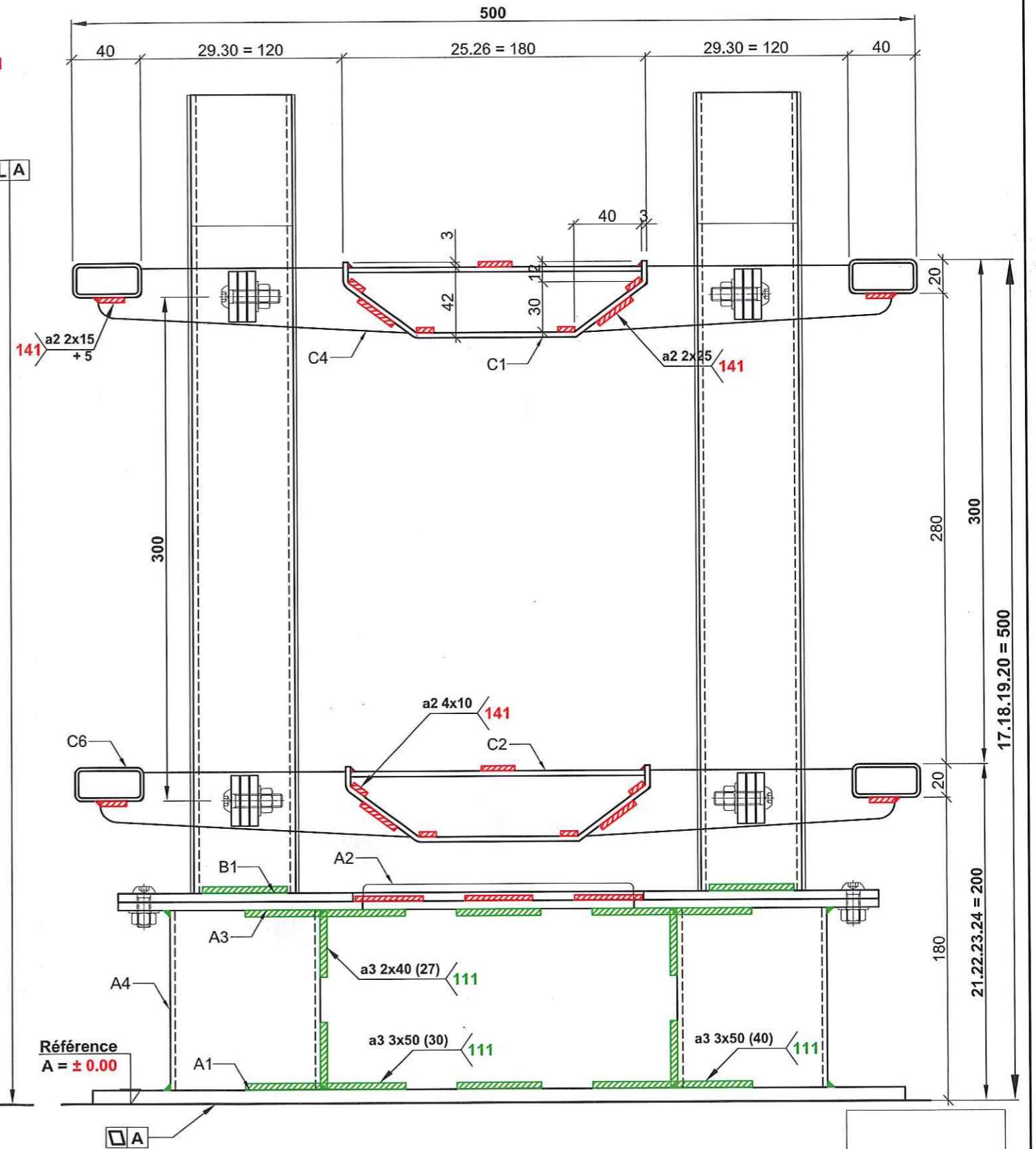

**1 Module Bas soudé 111**

## VUE EN PLAN

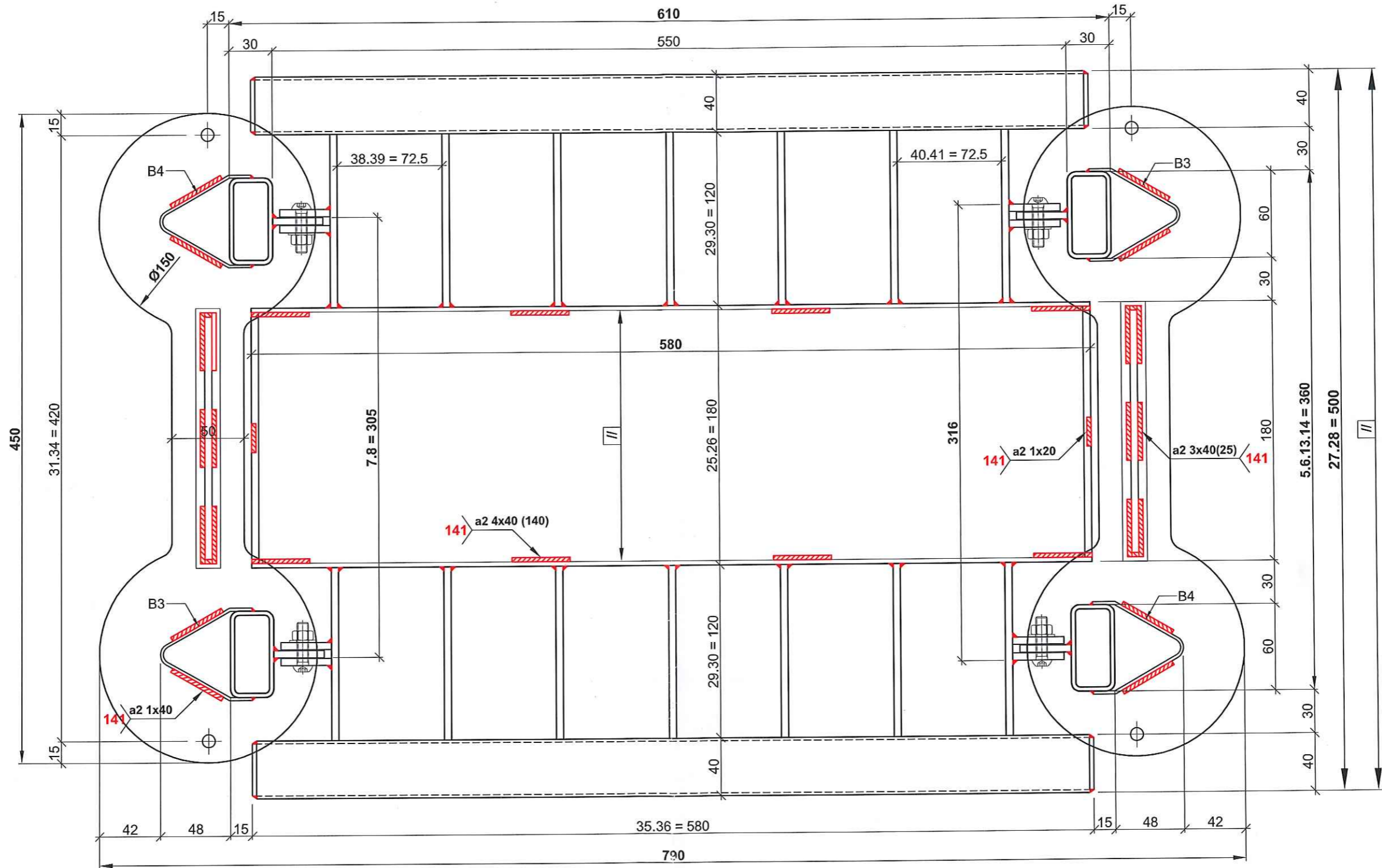

### SYMBOLES DE SOUDAGE

- 
**141** a2 4x40    **TIG** : Cordon épaisseur 2mm / Qté 4 / longueur 40mm
- 
**111** a3    **ARC** : Cordon épaisseur 3mm / périphérique
- 
**135** a4 2x50(30)    **SEMI-AUTO** : Cordon épaisseur 4mm / Qté 2  
 longueur 50mm / Espacés de 30mm

# VUE DE FACE LONGITUDINALE

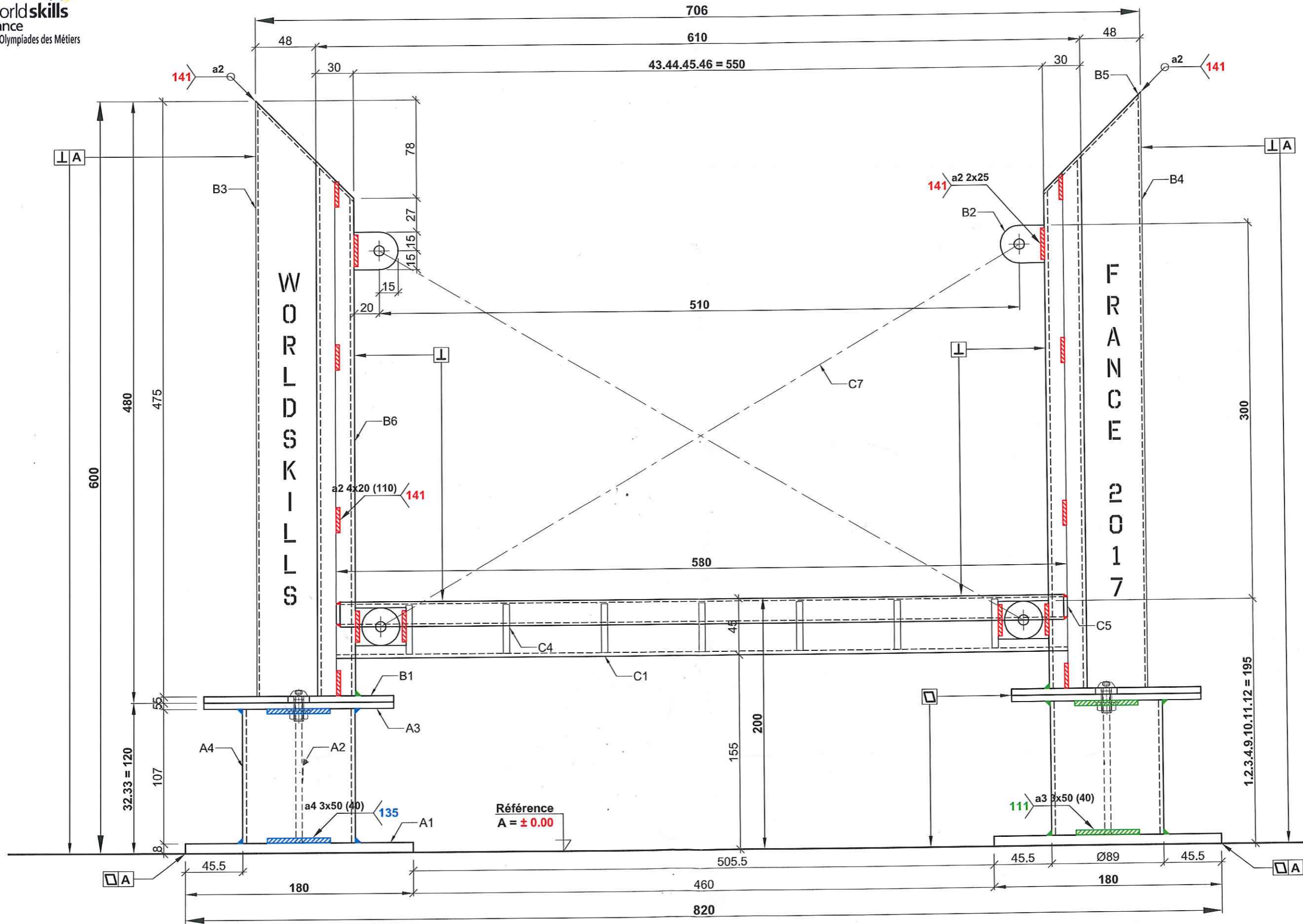

# DECOUPE LASER

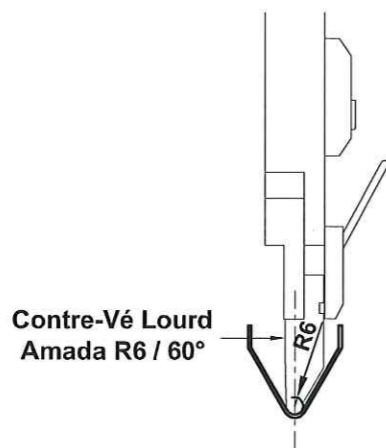

Acier ép.5mm  
Rep. A3  
Q=2

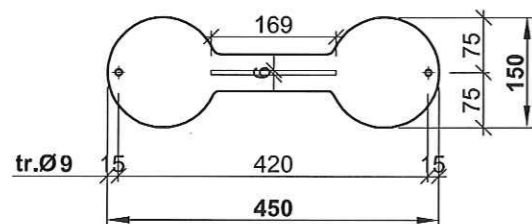

Acier ép.5mm  
Rep. A2  
Q=2

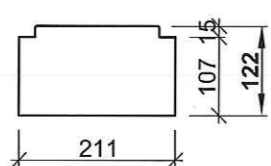

Acier ép.8mm  
Rep. A1  
Q=2

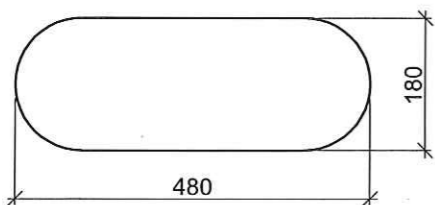

Inox ép.2mm  
Rep. B3  
Q=2

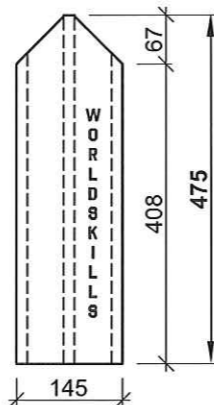

Inox ép.2mm  
Rep. B4  
Q=2

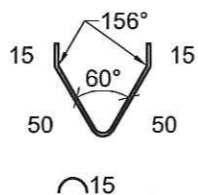
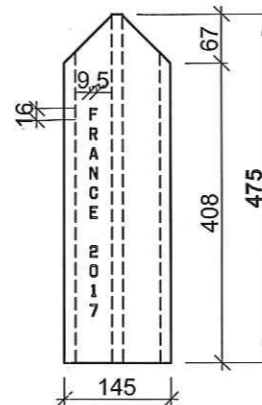

Acier ép.5mm  
Rep. B2  
Q=16

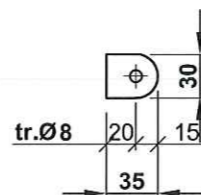

Inox ép.2mm  
Rep. B5  
Q=4

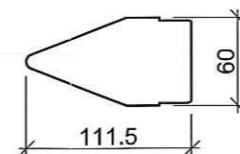

Acier ép.5mm  
Rep. B1  
Q=2

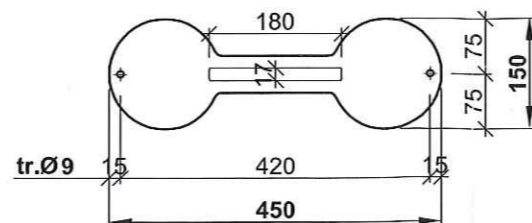

Acier ép.5mm  
Rep. C7  
Q=4

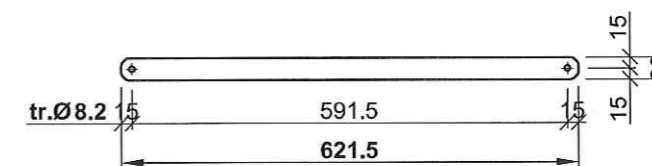

Acier ép.5mm  
Rep. C4  
Q=14

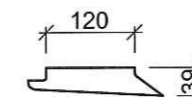

Acier ép.3mm  
Rep. C5  
Q=4

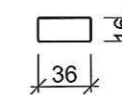

Acier ép.3mm  
Rep. C2  
Q=1

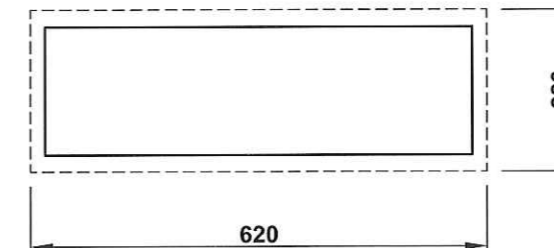

Acier ép.5mm  
Rep. C3  
Q=2

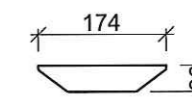

Acier ép.3mm  
Rep. C1  
Q=1

